

PS5010G-2GS-8PoE**8-Port 10/100/1000Base-T(X)+2 SFP ports****Managed Full Gigabit Industrial Ethernet PoE Switch****Features**

- Complies with IEEE 802.3i, IEEE 802.3u, IEEE802.3x , IEEE802.3ab , IEEE802.1q , IEEE802.1p standards
- Supports IEEE802.3af、IEEE802.3at standards
- Supports PoE power up to 30W for each PoE port, all power up to 140W
- Supports manage the POE port, support POE power off open the port, and port output power restriction
- Supports Web interface management
- 8 x 10/100/1000Mbps Auto MDI/MDI-X Ethernet port, supports ports Auto MDI/MDIX
- 8K entry MAC address table of the switch with auto-learning and auto-aging
- Supports IEEE802.3x flow control for Full-duplex Mode and backpressure for Half-duplex Mode
- supports QoS (quality of service), port mirror, Link aggregation protocol
- Supports packet length 9216Bytes jumbo frame packet forwarding at wire speed
- Supports 4KV Surge Immunity for all UTP ports
- LED indicators for monitoring PSE, Link / Activity/Speed

**Introduction**

The switch is a new generation designed for high security and high performance network the second layer switch. Provides eight 10/100/1000Mbps self-adaption RJ45 port, and two 100/1000Mbps SFP optical ports, all ports support wire-speed forwarding, can provide you with larger network flexibility. Support VLAN ACL based on port, easily implement network monitoring, traffic regulation, priority tag and traffic control. Support traditional STP/RSTP/MSTP 2 link protection technology; greatly improve the ability of fault tolerance, redundancy backup to ensure the stable operation of the network. Support ACL control based on the time, easy control the access time accurately. Support 802.1x authentication based on the

port and MAC, easily set user access. Perfect QOS strategy and plenty of VLAN function, easy to maintenance and management, meet the networking and access requirements of small and medium-sized enterprises, intelligent village, hotel, office network and campus network.

Its 8 ports have POE power supply function, support IEEE802.3at standard, 802.3af downward compatibility, power supply equipment for Ethernet, can automatically detect identification standard of electrical equipment, and through the cable for the power supply.

Application

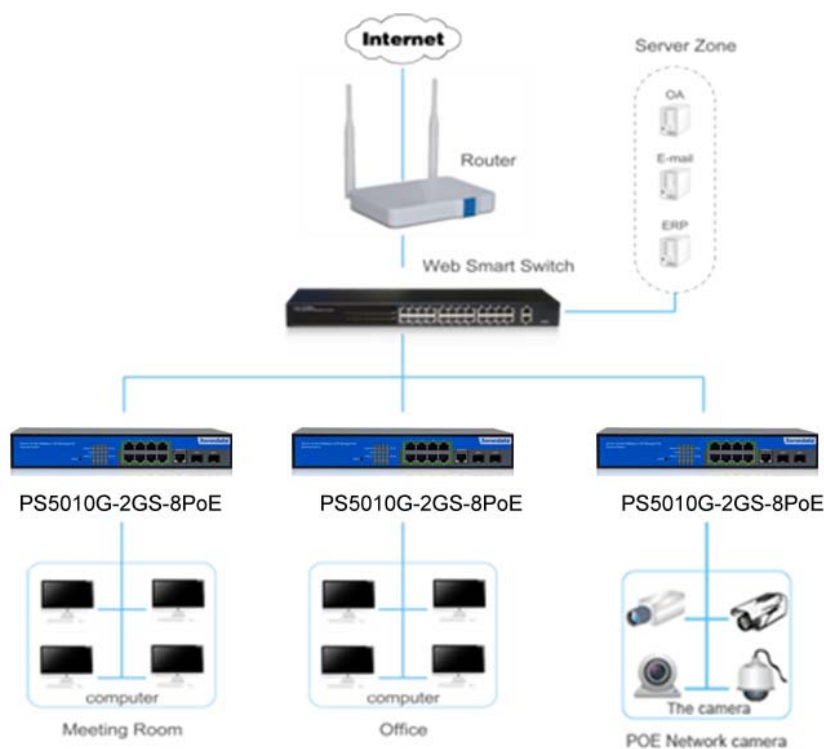

Specification

Technology

Standard: IEEE 802.3i, IEEE 802.3u, IEEE 802.3ab, IEEE 802.3x, IEEE 802.3z, IEEE 802.3at, IEEE 802.3af, IEEE 802.1q, IEEE 802.1p

Flow control: IEEE802.3x flow control

Function

Ethernet Setup, STP/RSTP/MSTP, Storm-Eontrol, Port Monitor, Port rate-limit, MAC filtering, The ARP deception, the network cheating, Filtering the IP port, Static binding IP and MAC, Arp trust port, Static routing capacity, Ping and Traceroute, ACE capacity, ACL, QoS, DAI, Port based VLAN, 802.1Q VLAN, Radius, Tacacs+, Preventing DOS attacks, dot1x, The gateway ARP deception, DHCP Relay, DHCP snooping, DHCP Client, FTP/TFTP, HTTP WEB, Telnet, SSH, Console, LLDP, IGMP Snooping, SNMPV1, V2c, V3, RMON(1,2,3,9), POE Status, Power supply management mode (auto/energy/static), The port priority

Exchange Attribute

1000M forward speed: 1488100pps

Transmit mode: store and forward

System exchange bandwidth: 20Gbps

MAC address table: 8K

Memory: 4.1Mbit

Interface

Electric port: 10/100/1000Base-T(X) auto negotiation speed, Full/Half duplex mode, auto MDI/MDI-X connection, and RJ45 connector.

Optical port: 100/1000Mbps SFP

Transfer Distance

Twisted cable: 100m (standard Cat3/Cat4/Cat5/Cat5e/Cat6 cables)

Optical cable:

1000Base-SX: 62.5μm/50μm MMF(2m~550m)

1000Base-LX: 62.5μm/50μm MMF(2m~550m) Or 10μm SMF(2m~5000m)

LED Indicator

Power indicator: PWR Green

Port link/act indicator

➤ 10/100Mbps Link/Act (1~8): Yellow

➤ 100Mbps Link/Act (1~8): Green

SFP indicator: SFP1/SFP2 Green

PoE indicator: PoE(1~8) Yellow

Power Supply

Power Pin Assignment: 1/2(+),3/6(-)

Input voltage: 100~240VAC,50/60HZ

Consumption

Maximum output via PoE: 140W

Maximum power consumption: 161W

Working Environment

Working temperature: -20~50℃

Storage temperature: -40~70℃

Working humidity: 10%~90% (non-condensing)

Storage humidity: 5%~90% (non-condensing)

Mechanical Structure

Dimensions (L×W×H): 280mm x 180mm x 44.3 mm

Warranty

3 years

Certification

CE, FCC, RoHS, UL508 (Pending)

Please check 3onedata's website for the most up-to-date certification status.